

Important Safety Instructions



Note:

- 1) Read these instructions.
- 2) Keep these instructions.
- 3) Heed all warnings.
- 4) Follow all instructions.
- 5) Do not use near water.
- 6) Clean only with dry cloth.
- 7) Do not block any ventilation openings. Maintain well ventilated conditions around the product. Do not put product on bed, sofa or anything that blocks ventilation. Install in accordance with the manufacturer's instructions.
- 8) Do not install near any heat sources such as radiators, heat registers, stoves, or other apparatus (including amplifiers) that produce heat.
- 9) Do not defeat the safety purpose of the polarized or grounding-type plug. A polarized plug has two blades with one wider than the other. A grounding type plug has two blades and a third grounding prong. The wide blade or the third prong is provided for your safety. If the provided plug does not fit into your outlet, consult an electrician for replacement of the obsolete outlet.
- 10) Protect the power cord from being walked on or pinched particularly at plugs, convenience receptacles, and the point where it exits from the apparatus.
- 11) Only use attachments/accessories specified by the manufacturer.
- 12) Use only with the cart, stand, tripod, bracket, or table specified by the manufacturer, or sold with the apparatus. When a cart is used, use caution when moving the cart/apparatus combination to avoid injury resulting from tip-over.
- 13) Unplug this apparatus during lightning storms or when unused for long periods of time.
- 14) Refer all servicing to qualified service personnel. Servicing is required when the apparatus has been damaged in any way, such as power-supply cord or plug is damaged, liquid has been spilled or objects have fallen into the apparatus, the apparatus has been exposed to rain or moisture, does not operate normally, or has been dropped.
- 15) Apparatus shall not be exposed to dripping or splashing and no objects filled with liquids, such as vases, shall be placed on the apparatus.



WARNING

The apparatus shall not be exposed to dripping or splashing and that no objects filled with liquids, such as vases, shall be placed on the apparatus.



The lightning flash with arrowhead symbol, within an equilateral triangle, is intended to alert the user of the presence of un-insulated “dangerous voltage” within the product’s enclosure that may be of sufficient magnitude to constitute a risk of electric to persons.



The exclamation point within an equilateral triangle is intended to alert the user of the presence of important operating and maintenance (servicing) instructions in the literature accompanying the appliance.

CAUTION: These servicing instructions are for use by qualified service personnel only. To reduce the risk of electric shock, do not perform any servicing other than that contained in the operating instructions unless you are qualified to do so. Refer to service manual for servicing instructions. To reduce the risk of fire or electric shock, do not expose this apparatus to rain or moisture.

The images in this manual are for reference only and they may be different from the actual ones.

Table of content

Important Safety Instructions	1
Catalogue	3
Getting Started	4
Connecting to External AV Source	4
Connecting headphone	4
Connecting the power cable	5
Turning on the unit	5
Knowing Your Unit	6
Front View	6
Right View	6
Back View	6
Remote Control	7
Overview	7
Using Remote Control	7
Install Remote Control to the Unit	7
Doing More	8
ATSC SETUP	8
Picture Setting	8
Audio Setting	8
Time Setting	9
Option Setting	10
CHANNEL Setting	11
Troubleshooting	14
Specification	15

Your mini-TV comes with a built-in lithium rechargeable battery. Charge the battery fully before initial use.

There are two ways to use the unit: Use the AC Adapter to power it or use the built-in battery.

Connecting the power cable

Use the plug that accommodates your type of power outlet.

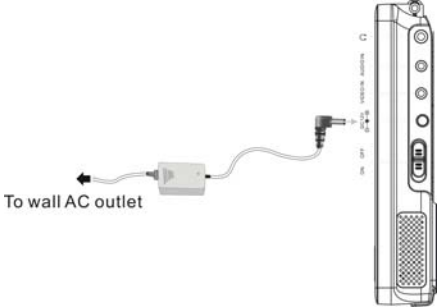

Turning on the unit



Slide the power latch toward the arrow and hold it for a few seconds to turn on the unit.

Note: When the charge of the battery is weak, low power indicator will appear on the LCD screen. The unit will turn off automatically several minutes later.

Knowing Your Unit

Front View

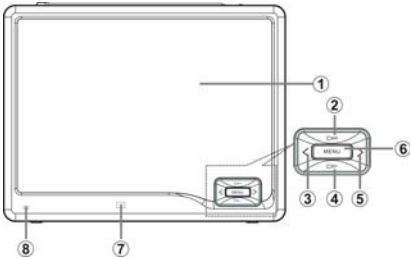

- 1. LCD Screen
- 2. CH+
- 3. VOL<
- 4. CH-
- 5. VOL>
- 6. **MENU**
- 7. Remote Sensor
- 8. Power Indicator

Right View

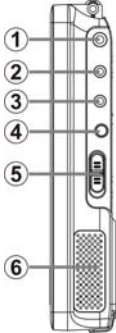

- 1. Headphone Jack
- 2. Audio Jack
- 3. AV IN Jack
- 4. **DC 12V Jack**
- 5. Power Switch
- 6. Speaker

Rear View

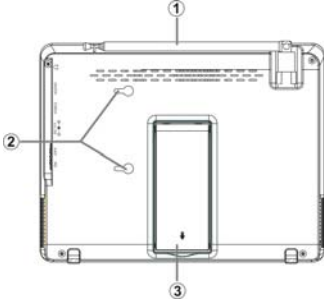

- 1. Antenna
- 2. Mounting Holes
- 3. Bracket

Remote Control

➤ Overview

1. CH+
2. CH-
3. VOL-
4. VOL+
5. CH+10
6. MENU



➤ Using Remote Control

Point the remote control unit to the remote sensor within the range of 5 meters and angles of 60 degrees, and without obstacles between remote control and remote sensor.

Note

- Improper use of the battery may cause overheating, explosion or ignition, which can result in an injury or a fire. Battery leakage may damage the remote control.
- Do not expose the remote control unit to direct sunlight.
- Do not recharge, disassemble, deform or heat the battery.
- Do not put the battery in fire or water.
- Immediately replace the exhausted battery.
- Remove battery when the remote is not in use for a long time.

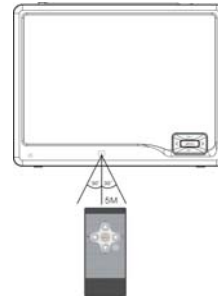

➤ Install Remote Control to the Unit

Install the RC slot to the mounting holes first as per the below arrow direction; then put the remote control to the RC slot, that is more convenient when using the remote control.

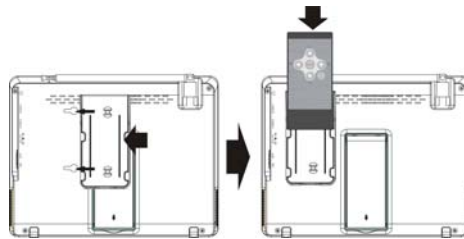

Doing More

All buttons and controls are described on the board unless otherwise specified.

ATSC SETUP

After connection, press the MENU button to enter the TV SETUP menu, press it again to exit from the menu.

➤ **Picture Setting**

Press the ◀ ▶ button to shift among the submenus.

Press the ▲ ▼ button to select the desired item. Press the MENU button to exit the menu.

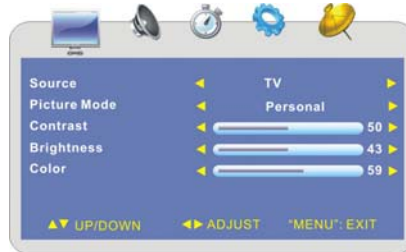

Source

Press the ▲ ▼ button to select **Source** and press the ◀ ▶ button to select TV, AV.

Picture Mode

Press the ▲ ▼ button to select **Picture Mode** and press the ◀ ▶ button to select Personal, Standard, Dynamic or Soft.

Contrast (Brightness, Color)

Press the ▲ ▼ button to select **Contrast/Brightness/Color** and press the ◀ ▶ button to enter the menu shown on the right. Within the menu, press the ◀ ▶ button to adjust the value. Press the MENU button to return to the previous menu.

➤ **Audio Setting**

Press the MENU button once to enter the setup menu. Press the ◀ ▶ button to select **AUDIO** and to enter the menu shown on the right.

In the menu, press the ▲ ▼ button to select the desired item. Press the MENU button to exit the menu.



Sound Mode

Press the ▲▼ button to select **Sound Mode** and press the ◀▶ button to select Personal, Standard, Music or Movie.

Bass

Press the ▲▼ button to select **Bass** and press the ◀▶ button to adjust the level.

Balance

Press the ▲▼ button to select **Balance** and press the ◀▶ button to adjust the level.

Treble

Press the ▲▼ button to select **Treble** and press the ◀▶ button to adjust the level.
Press the MENU button to return to the previous menu.

Audio Language

Press the ▲▼ button to select **Audio Language** and press the ◀▶ button to select the desired audio language. Press the MENU button to return to the previous menu.

Note: This item is only available under ATSC signal mode.

➤ *Time Setting*

Press the MENU button once to enter the setup menu. Press the ◀▶ button to select **TIME** and to enter the menu shown on the right.

In the menu, press the ▲▼ button to select the desired item.

Press the MENU button to exit the menu.



OSD Duration

Press the ▲▼ button to select OSD Duration and press the ◀▶ button to select the desired value of the time the menu will be displayed on the screen.

Time Zone

Press the ▲▼ button to select **Time Zone** and press the ◀▶ button to select the desired time zone.

Daylight Saving Time

Press the ▲▼ button to select **Daylight Saving Time** and press the ◀▶ button to select On or Off. Press the SETUP button to return to the previous menu.

Clock

Press the ▲▼ button to select **Clock** to display the system time. Press the SETUP button to return to the previous menu.

Note: This item is only available under signal mode.

➤ **Option Setting**

Press the MENU button once to enter the setup menu. Press the ◀▶ button to select **OPTION** and to enter the menu shown on the right.

In the menu, press the ▲▼ button to select the desired item.

Press the MENU button to exit the menu.



Language

Press the ▲▼ button to select **Menu Language** and press the ◀▶ button to select the desired language.

Transparency

Press the ▲▼ button to select **Transparency** and press the ◀▶ button to select On or Off.

Color Mode

Press the ▲▼ button to select **Color Mode** and press the ◀▶ button to select Normal, Warm or Cool.

Zoom Mode

Press the ▲▼ button to select **Zoom Mode** and press the ◀▶ button to select Normal or Wide.

Closed Caption

Press the ▲▼ button to select **Closed Caption** and press the ► button to enter its submenu as shown on the right:
In this menu, press ▲▼ button to select the desired items.



1. CC Mode

Press the ▲▼ button to select **CC Mode** and press the ◀▶ button to select Off, On or CC on Mute. Press the SETUP button to return to the previous menu.

2. Basic Selection

Press the ▲▼ button to select **Basic Selection** and press the ◀▶ button to select CC1, CC2, CC3, CC4, Text1, Text2, Text3 or Text4. Press the SETUP button to return to the previous menu.

3. Advanced Selection

Press the ▲▼ button to select **Advanced Selection** and press the ◀▶ button to select Service1, Service2, Service3, Service4, Service5 or Service6. Press the SETUP button to return to the previous menu.

Note: The item is only available under ATSC signal.

Restore Setting

Press the ▲▼ button to select **Restore Setting** and then press the ► button to enter the menu.

Press ◀▶ button to select "YES" and press the MENU button to reset the setting to default status; select "NO" and press the MENU button to cancel and return.

➤ CHANNEL Setting

Press the MENU button once to enter the setup menu. Press the ◀▶ button to select **CHANNEL** and press the MENU button to enter the menu as shown on the right.

In the menu, press the ▲▼ button to select items.

Press the MENU button to exit the menu.



Antenna

Press the ▲▼ button to select **Antenna** and press the ◀▶ button to select CATV or Air.

Auto Scan

Press the ▲▼ button to select **Auto Scan** and press the ▶ button to enter the menu as shown on the right:



1. Cable System

Press the ▲▼ button to select **Cable System** and press the ◀▶ button to select the desired item.

Note: This item is only available when “Antenna” is set to “CATV”.

2. Start to Scan

Press the ▲▼ button to select **Start to Scan** and press the ▶ button to start the scanning.

After scanning, the unit will automatically memorize the programs searched in sequence and tune the first searched channel.

During scanning, press the MENU button to cancel and exit.



Channel Skip

Press the ▲▼ button to select **Channel Skip** and press the ▶ button to enter the menu as shown on the right:

Within this menu, press the ▲▼ button to select the channel you want to skip and press the ◀▶ button to select On or Off. Press the MENU button to return to the previous menu.

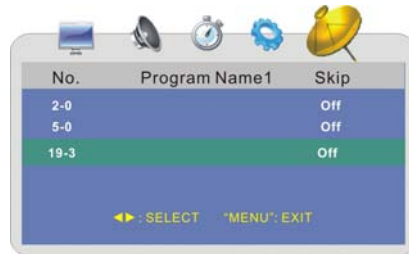

Channel No.

Press the ▲▼ button to select **Channel No.** and press the ◀▶ button to select the channel number.

Channel Label

Press the ▲▼ button to select **Channel Label** and press the ▶ button to enter the menu as shown on the right:

Within this menu, press the ◀▶ button to highlight position and press the ▲▼ button to select the desired character or symbol.

Press the MENU button to return to the previous menu.

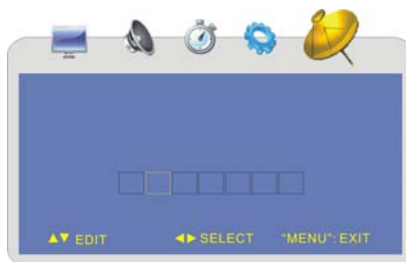

Troubleshooting

SYMPTOM	CHECK ITEM
There is no sound.	Make sure the system connections are correct. Make sure the speakers are not muted. In the TV mode, set the correct sound mode.
LCD is no display	Make sure the unit is turned on and the connections are correct. Make sure the power adapter is correctly connected.
There is no picture or picture jitters up and down unsteady.	Check if the connections with the external AV signal source are correct. Correctly set the items in the picture menu. Check if the video type input signal is not corresponding to the unit. Make sure the unit is turned on and in the correct video type.
The remote control does not work.	Make sure there are no obstructions between the remote control and the player. Make sure the remote control is pointing at the player. Make sure batteries are inserted and the polarity is correct. Make sure batteries are not weak.

Other Notes:

Static or other external interference may cause the player to behave abnormally. If this occurs, unplug the power-supply cord from the outlet and plug it in again to reset the player. If the problems persist, then please disconnect the power and consult a qualified technician.

Specification

Display:

7" TFT LCD

Resolution:

480X234

Size:

186x29x144 (WxDxH)

Power consumption:

<20W

Power:

AC adaptor:

input AC 100~120V, output DC 12V/2A

Weight:

About 250g